

RoHS PASS

REV	ECN NO	LOCATIONS	DESCRIPTION	DATE	DESIGN
A1			NEW RELEASED	08/18'07	James
A2	SZ0810004		PLUS SHELL FINISH(EXPRESS)	10/15'08	yangliu
A3	SZ0904019		PLUS SHELL FINISH(EXPRESS)	04/23'09	yangliu
A4	SZ0907041		PLUS SHELL FINISH:G-GOLD PLATED	07/20'09	yangliu
A5	SZ0907049		ALTER OPERATING TEMPERATURE	09/11'09	yangliu
A6	SZ1003005		PLUS SHELL FINISH:G-GOLD PLATED	03/10'10	yangliu
A7	SZ1105054		PLUS SHELL FINISH:E	05/25'11	yangliu

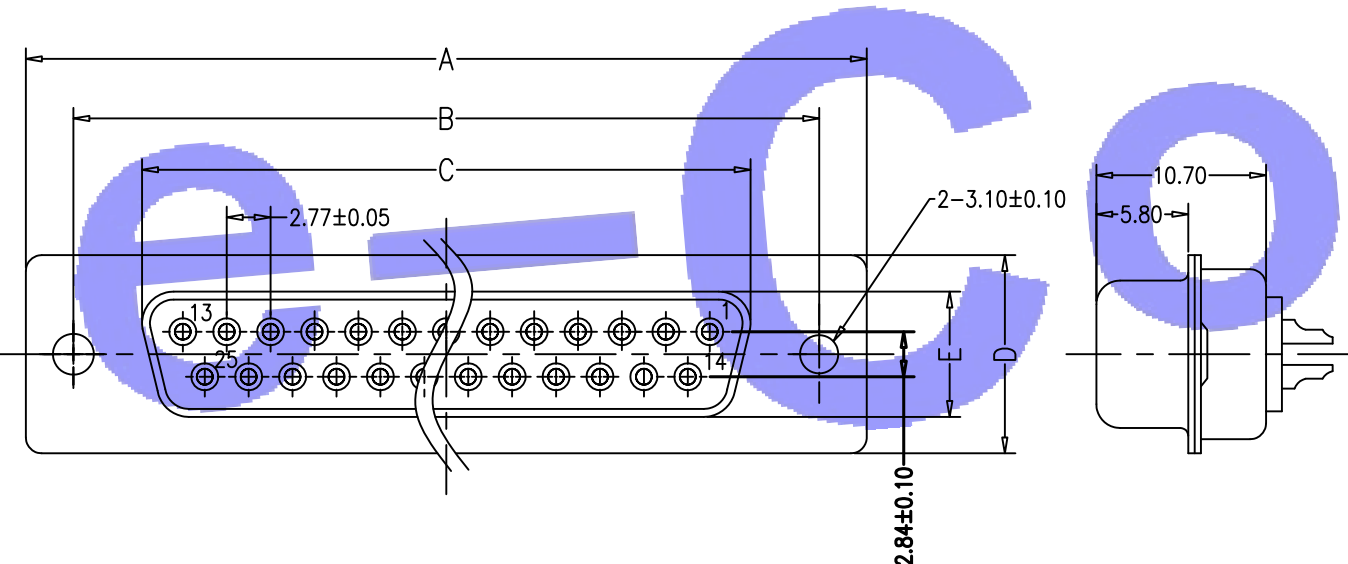
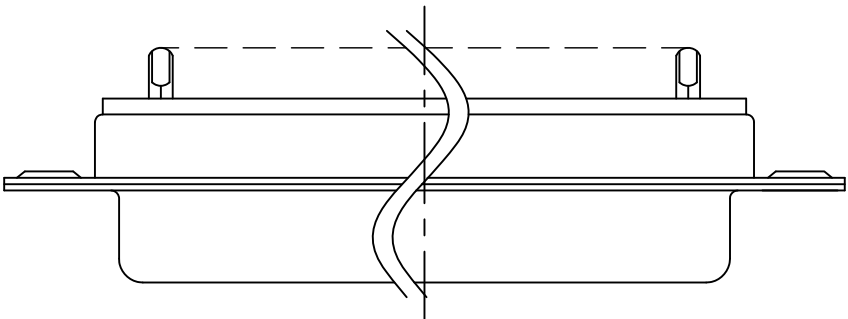

ELECTRICAL CHARACTERISTICS
Contact Current Rating: 1 Amperes.
Dielectric Withstanding Voltage: AC 1000 V r.m.s.
Insulation Resistance: 1000 Megohms Minimum at DC 500V.
Contact Resistance: 25 Milliohms Maximum.
Operating Temperature: -55°C~105°C

MATERIALS:
Contacts: Copper Alloy.
Insulator: PBT+Class Fiber, UL 94V-0 Rated
Shell: Cold Roller Steel.

DSBX-XXFX-XXSO-00

5-ROHS

Pin Number:
09-9PIN
15-15PIN
25-25PIN
37-37PIN

Shell Finish(Currently):
1-Front Ni & Back Tin
T-Tin
G-Gold Plated

Insulator Color:
K-Black
B-Blue.
W-White

Contact Finish:
1-Gold Flash
2-Selective Gold 3u"
3-Selective Gold 5u"
4-Selective Gold 10u"
5-Selective Gold 15u"
6-Selective Gold 20u"
7-Selective Gold 30u"

POSITION	A±0.35	B±0.25	C±0.25	D±0.25	E±0.10
DS-09S	30.80	25.00	16.30	12.50	7.90
DS-15S	39.20	33.30	24.60	12.50	7.90
DS-25S	53.05	47.05	38.30	12.50	7.90
DS-37S	69.40	63.50	54.80	12.50	7.90

DIM	TOL	DEC	TOL
X.	±1.0	X.*	±1"
X.X	±0.38	X.X*	±0.5"
X.XX	±0.25	X.XX*	
X.XXX	±0.10	X.XXX*	

e-Conn

苏州正耀电子有限公司

ELECTRONIC(SU-ZHOU) CO., LTD

DRAW NO:

DESIGN:

CHECK:

REVIEW:

APPROVED:

杨柳

范远平

蒋乐

蒋乐

DATE

05/25'11

MATERIAL:

FINISH: /

FILE: /

P/N NO: DSBX-XXFX-XXSO-00

REV: A7

SCALE: N/A

DRAW NAME:

D-SUB XXPIN FEMALE SOLDER TYPE

MODEL:

UNIT: mm

SHEET 1/1